

PRODUCT DESCRIPTION

- » With integrated length adjustment screw
- » High clamping forces
- » Optimal workpiece surfaces and longer service lives thanks to very good damping properties
- » Best concentricity
- » With Balluff chip hole

APPLICATION

- » For clamping tools with cylindrical shank and h6 shank tolerance
- » Use in combination with reduction sleeve enables flexible clamping
- » For drilling, reaming and milling

INCLUDED IN THE DELIVERY

- » Includes built-in length adjustment screw, user guide and hexagon key

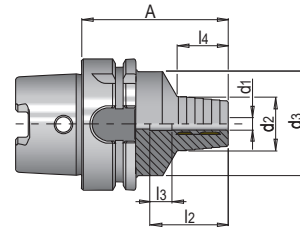

d2	d3	l2	l3	l4	Interface	d1	A	No.	EUR
26	50	37	10	24	HSK-A 63	6	70	HWZ 1161/HSK-A 63/ 6/ 70	<>
28	50	37	10	25	HSK-A 63	8	70	HWZ 1161/HSK-A 63/ 8/ 70	<>
30	50	41	10	35	HSK-A 63	10	80	HWZ 1161/HSK-A 63/10/ 80	<>
32	50	46	10	40	HSK-A 63	12	85	HWZ 1161/HSK-A 63/12/ 85	<>
38	50	49	10	46	HSK-A 63	16	90	HWZ 1161/HSK-A 63/16/ 90	<>
42	50	51	10	48	HSK-A 63	20	90	HWZ 1161/HSK-A 63/20/ 90	<>